



HM...TC-AC/* Turbine Flow Meters for High Pressure Applications



This turbine series has Auto Clamp connections for pressures up to 1,500 bar. It is made from stainless steel using the following materials:

- Housing: DIN 1.4571/AISI SS316 Ti or DIN 1.3980 (X8NiCr17-10)
- Internal parts: DIN 1.4571/AISI SS316 Ti
- Wheel: DIN 1.4460/AISI SS329
- Bearings: tungsten carbide

General information like measuring principle may be taken from the datasheet »HM series«.

For high flow rates turbines with BASF high-pressure flanges are available.



pickup bore with discharging groove

Technical Data

Type	Meas. range ltr/min	Mean K-factor ¹⁾ pulses/ltr	Frequency 0–max. Hz
HM 003/TC-AC/*	0.3 up to 1.5	32,500	1,000
HM 004/TC-AC/*	0.5 up to 4	25,000	1,250
HM 005/TC-AC/*	0.8 up to 6	17,800	1,740
HM 006/TC-AC/*	1.2 up to 10	10,300	1,750
HM 007/TC-AC/*	2 up to 20	5,000	1,667
HM 009/TC-AC/*	3.3 up to 33	5,000	2,750

1) Average values, the exact values can be taken from the calibration record supplied with each flow meter.

Linearity: $\pm 1.0\%$ of actual flow, HM 009: $\pm 1.5\%$ of actual flow at 1 cSt

Dimensions (mm)

HM 003, HM 004

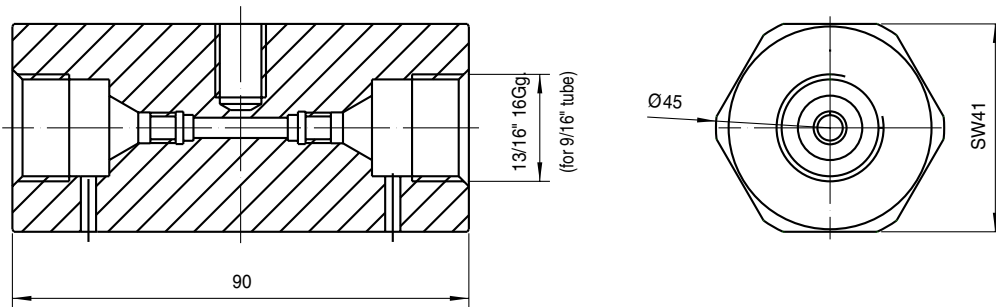

HM 005, HM 006

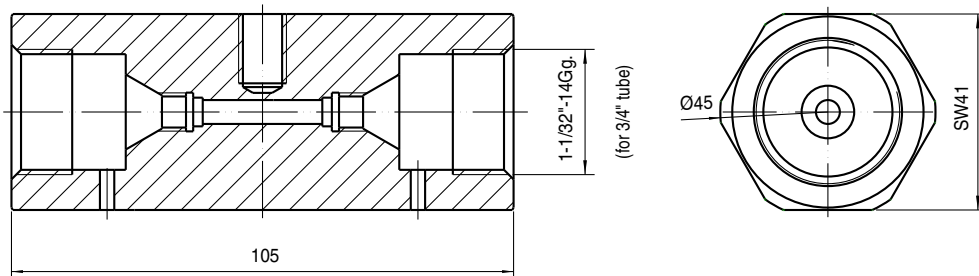

HM 007, HM 009

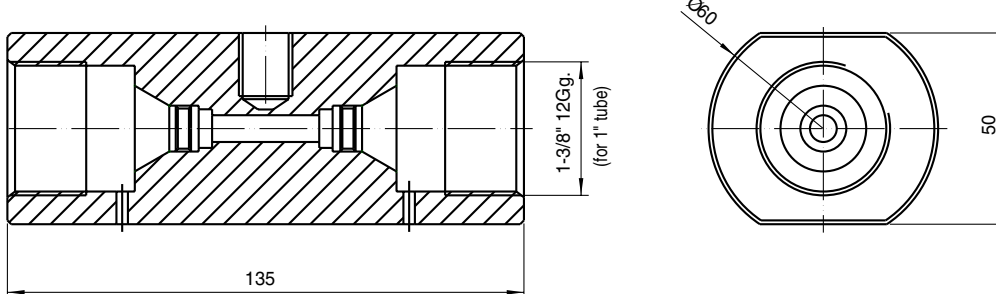

Copyright KEM, Subject to change without notice, Zi Rev. 001/02/07

Internet
<http://www.kem-kueppers.com>



Küppers Elektromechanik GmbH

Flow Meters and Electronics: Design • Manufacture • Distribution